

# SECTION A-A

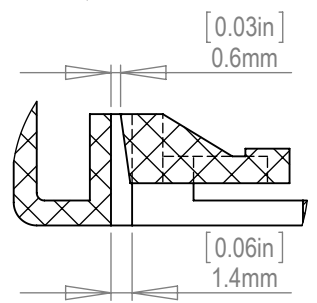

# DETAIL C SCALE 2 : 1

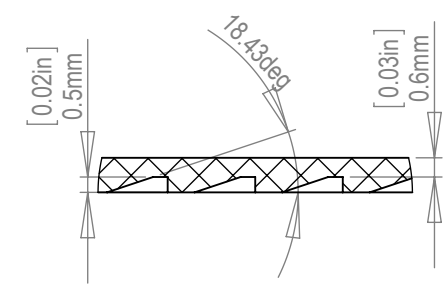

# DETAIL B SCALE 4 : 1

**PROPRIETARY AND CONFIDENTIAL**  
THE INFORMATION CONTAINED IN THIS DRAWING IS THE SOLE PROPERTY OF CPI INC. ANY REPRODUCTION IN PART OR AS A WHOLE WITHOUT THE WRITTEN PERMISSION OF CPI INC. IS PROHIBITED.

		UNLESS OTHERWISE SPECIFIED:		NAME	DATE	CUSTOMER: <b>CPI Inc.</b>	
		DIMENSIONS ARE IN INCHES		DRAWN	ChrisJohn	TITLE: <b>Quick Release Tie Strap</b>	
		TOLERANCES:		CHECKED			
		FRACTIONAL $\pm 1/16$ th		ENG APPR.			
		ANGULAR: MACH $\pm$ BEND $\pm$		MFG APPR.		PART NO. <b>EPN-111-05-500-00</b>	
		TWO PLACE DECIMAL $\pm 0.05$		Q.A.		SIZE <b>A</b> DWG. NO. <b>EPN-111-05-500-00</b> REV <b>0</b>	
		THREE PLACE DECIMAL $\pm 0.01$		COMMENTS:			
		INTERPRET GEOMETRIC TOLERANCING PER:				Wt: 0.01 gm	
		MATERIAL <b>Nylon 6/10</b>				SHEET 1 OF 1	
		FINISH <b>TBD</b>					
NEXT ASSY	USED ON	APPLICATION	DO NOT SCALE DRAWING				